

# RESIZE YOUR TEMPLATE IN ADOBE ILLUSTRATOR *for scroll saw artists*

Double click your ZIP file to decompress and access all the file types.

Open the SVG file with Adobe Illustrator.

Make sure your artboard measuring units are in INCHES. This is located in the Properties Menu in the upper right hand corner.

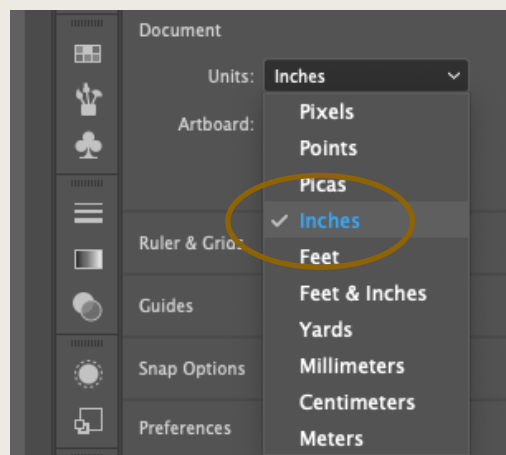

Select your entire design (including the circle) and adjust your measurements in the Properties menu to your desired backer size.

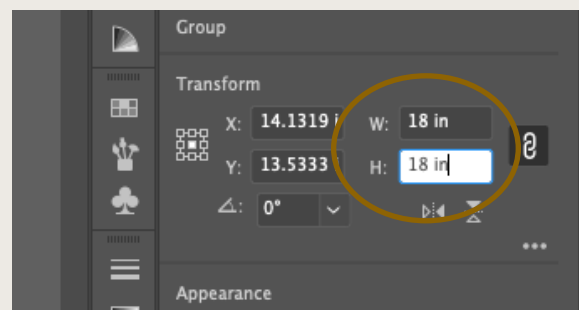
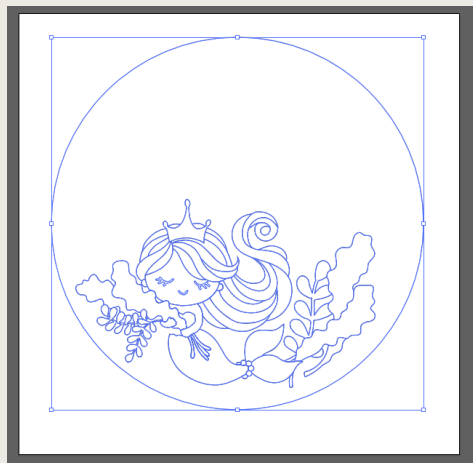

If you do not want to print the circle, click on the circle path and delete. Select the entire remaining design and move it to the upper left corner of your artboard.

(If you want to print it at a local printer I recommend keeping the circle)

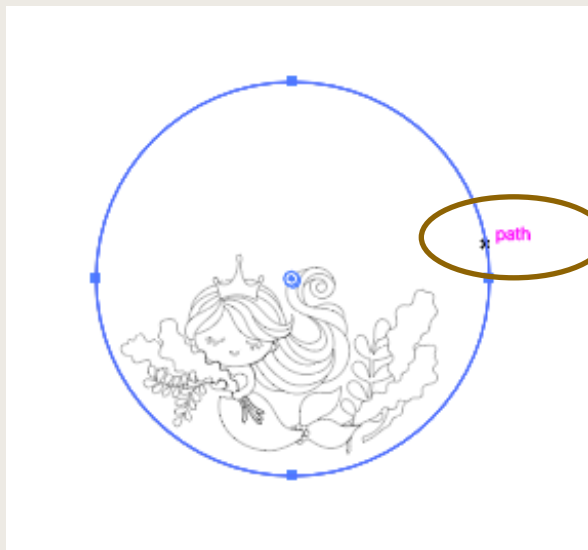

To print it on your home printer.  
Select File- Print

Adjust your settings to the following:

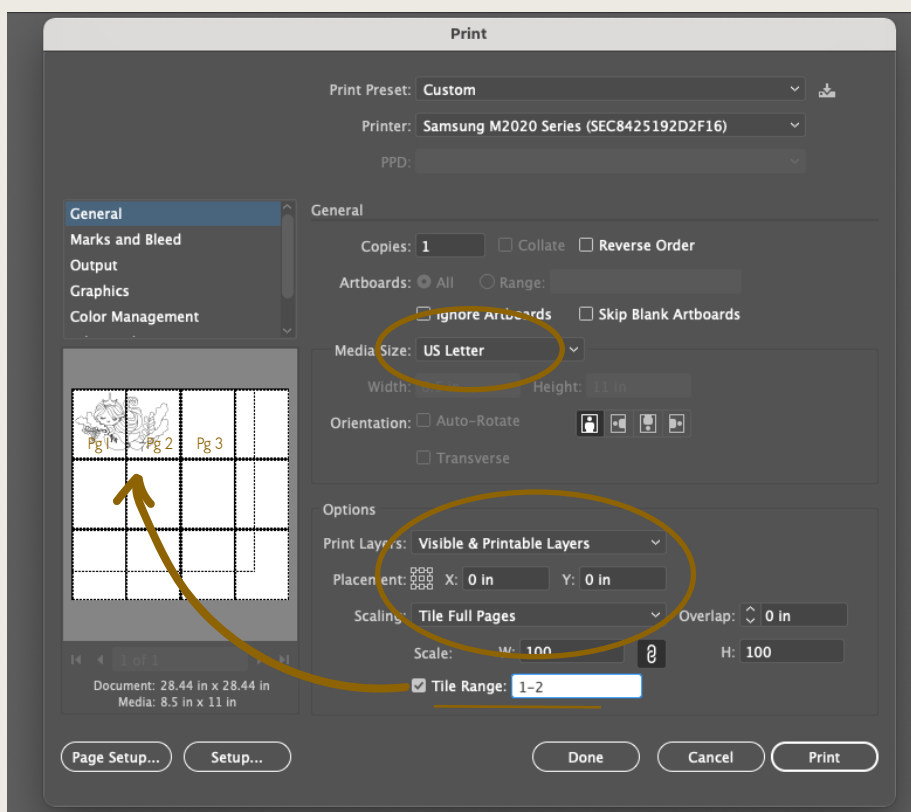

To print your file at a local printer (I use UPS)  
Adjust your Artboard to the size of your backer.

Click on "Edit Artboard" and change the measurements  
in the Properties menu in the upper right hand corner  
of your screen.

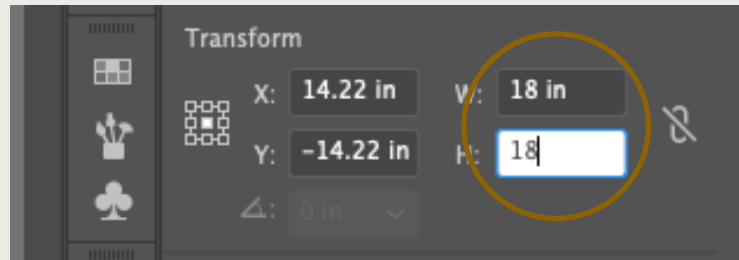
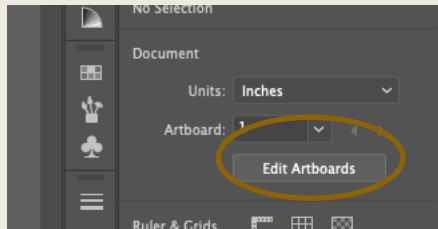

Center your design with the circle  
Save file as a PDF

Email to your local UPS.  
They can print it using their large format printer in an Engineer Print.  
Tell them the dimensions of your backer.

For example: Adella.pdf - 18x18

